

INDUSTRIAL LIGHTING

— 20
24 CATALOG

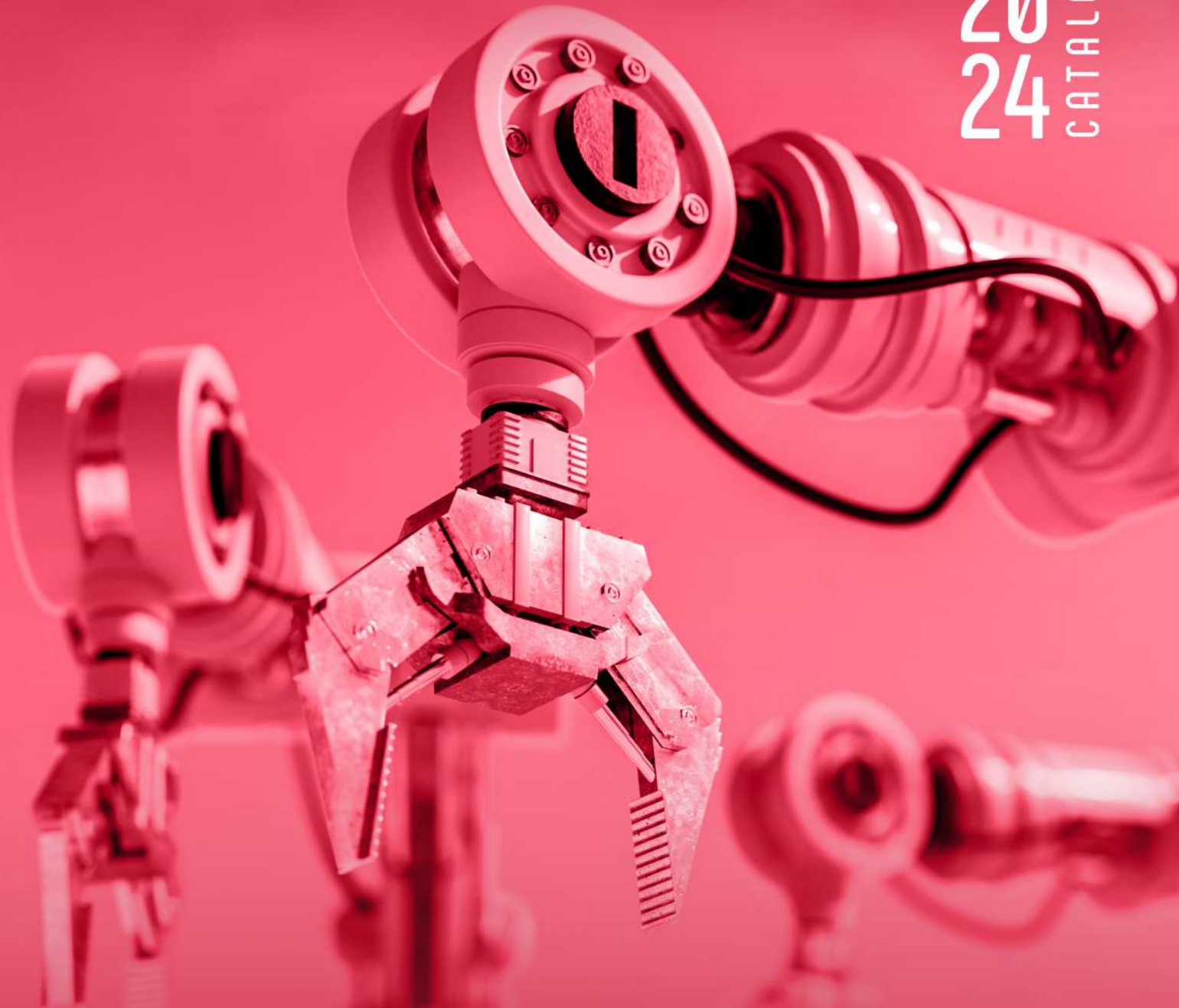



Quality in production shaped by details, **Efficient lighting shows all the details.**



Industrial applications often require efficient, safe and robust lighting that can withstand a harsh environment. Reliability and service life are critical in manufacturing environments where change is not always easy. However, lighting is also an important investment that must pay off.

Industrial applications require durable lighting: resistant to dust and moisture, extreme temperatures, gases and chemicals. At the same time, performance is also very important. Well lit workplaces and warehouses not only increase the efficiency of your staff and processes, but also increase safety in the workplace.



FORCE



Easy electrical installation by glass without screws
Quick and easy access to components

FORCE high bay luminaire series are used in industrial facilities, warehouses, gyms and airports. With their stylish design, they produce professional solutions according to the needs, offer the user a safe working environment, are easy to maintain and intervene, have a soft form, minimal, holistic structure where engineering solutions and design are combined.

It is a functional luminaire. FORCE high bay luminaires have a solid structure and excellent thermal heat distribution thanks to their aluminum extrusion profile body. Using high efficiency LED chips and drivers, the fixture has a lifespan of at least 50.000 and up to 100.000 hours.

All these features distinguish FORCE from its peers. These lighting fixtures can be used compatible with smart control systems and DALI dimming solutions.

With external motion sensor, it can be automatically turned on or automatically turn off according to detected motion. These luminaires can be produced to suit different mounting options.



- Design compatible with different mounting and hanging details.
(Busbar, Cable Tray, Angled Apparatus)
- Different optics are suitable for lens use.
- Shock resistant body, tempered transparent glass.
- Has a long-lasting, non-deformation silicone gasket and sealing gasket.
- Screwless window opening and closing, fast and easy intervention to the LED-Lens-Driver part.
- Efficiency up to max. 155 lm/W
- Side covers are made of special fireproof composite material.
- The closed-line design of the upper part of the body prevents the accumulation of dust and particles and does not pose a risk in terms of occupational safety.
- There are three versions developed for standard, cold and hot environments.
- IP65 protected against liquid and dust. Impact resistance IK08
- Cage protection system for sports fields.
- High bay sensor option (On-off,DALI)
- Suitable design for wireless connectivity technology.

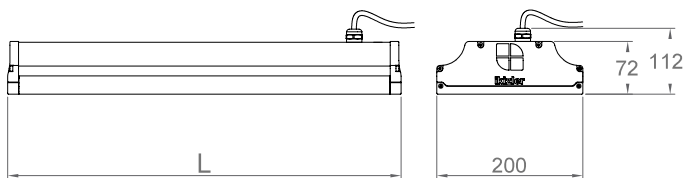

MECHANICAL SPECIFICATIONS

Body	Electrostatic powder coated aluminum profile
Diffuser	Tempered clear glass
Ingress Protection	IP65
Impact Protection	IK08
Cable	3 x 0,75 mm ²
RAL Code	RAL 7016
Mounting Type	Cable tray/Busbar/Surface mounted

OPTICAL SPECIFICATIONS

Optic	High efficiency acrylic lens (PMMA)
Beam Angles	30°/60°/90°/ 20°x100° Symetrical
Unified Glare Rating (UGR)	≤ 22
Color Rendering Index (CRI)	Ra ≥ 80
Color Temperature	Standard 4000K

ELECTRICAL SPECIFICATIONS

Driver	Constant current output , Pf>0.95 Industry series
Operating Temperature	-20 °C / +45 °C
Input Voltage / Line Frequency	220 -240 VAC / 50- 60 Hz
LED Life Time	L90B10>50.000 hours
Surge Protection Devices (SPD)	Up to 4 kV (L-N) / (L/N-PE)
Glow Wire	650°C
Class-I	

OPTIONS

- *DALI DIM
- *1-10V DIM
- *DC operating mode
- *Emergency kit (1h/3h)
- *Microwave sensor
- *5700K-6500K
- *Security glass film
- *Protective cage for sports fields

Order Code	W	Lm	CCT	L (mm)	Kg
07308.4S.40.100	69	10500	4000	445	3,5
07308.4S.40.150	97	14700	4000	445	3,5
07308.6S.40.202	133	20000	4000	595	5,1
07308.7S.40.226	170	25400	4000	745	6,6
07308.8S.40.327	235	32800	4000	845	7,5
07308.1S.40.420	305	42000	4000	1045	8,2

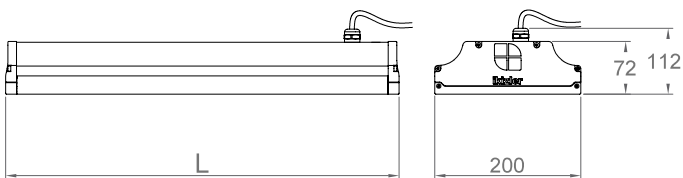

MECHANICAL SPECIFICATIONS

Body	Electrostatic powder coated aluminum profile
Diffuser	Tempered clear glass
Ingress Protection	IP65
Impact Protection	IK08
Cable	3 x 0,75 mm ²
RAL Code	RAL 7016
Mounting Type	Cable tray/Busbar/Surface mounted

OPTICAL SPECIFICATIONS

Optic	High efficiency acrylic lens (PMMA)
Beam Angles	30°/60°/90°/ 20°x100° Symetrical
Unified Glare Rating (UGR)	≤ 22
Color Rendering Index (CRI)	Ra ≥ 80
Color Temperature	Standard 4000K

ELECTRICAL SPECIFICATIONS

Driver	Constant current output , Pf>0.95 Industry series
Operating Temperature	-40 °C/+60 °C
Input Voltage / Line Frequency	220 -240 VAC / 50- 60 Hz
LED Life Time	L90B10>50.000 hours
Surge Protection Devices (SPD)	Up to 4 kV (L-N) / (L/N-PE)
Glow Wire	650°C
Class-I	

OPTIONS

- *DALI DIM
- *1-10V DIM
- *DC operating mode
- *Emergency kit (1h/3h)
- *Microwave sensor
- *5700K-6500K
- *Security glass film
- *Protective cage for sports fields

Order Code	W	Lm	CCT	L (mm)	Kg
07308.4C.40.105	69	10500	4000	445	3,5
07308.6C.40.170	110	16700	4000	595	5,1
07308.7C.40.226	145	20800	4000	745	6,6

* Emergency lighting units (+5°C/+35°) are generally not suitable for cold environment conditions.
Consult the manufacturer for emergency kit use.

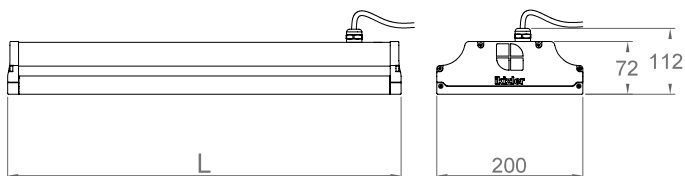

MECHANICAL SPECIFICATIONS

Body	Electrostatic powder coated aluminum profile
Diffuser	Tempered clear glass
Ingress Protection	IP65
Impact Protection	IK08
Cable	3 x 1,5 mm ²
RAL Code	RAL 7016
Mounting Type	Cable tray/Busbar/Surface mounted

OPTICAL SPECIFICATIONS

Optic	High efficiency acrylic lens (PMMA)
Beam Angles	30°/60°/90°/ 20°x100° Symetrical
Unified Glare Rating (UGR)	≤ 22
Color Rendering Index (CRI)	Ra ≥ 80
Color Temperature	Standard 4000K

ELECTRICAL SPECIFICATIONS

Driver	Constant current output , Pf>0.95 Industry series
Operating Temperature	-40 °C/+60 °C
Input Voltage / Line Frequency	220-240 VAC / 50-60 Hz
LED Life Time	L90B10>50.000 hours
Surge Protection Devices (SPD)	Up to 4 kV (L-N) / (L/N-PE)
Glow Wire	650°C
Class-I	

OPTIONS

- *DALI DIM
- *1-10V DIM
- *DC operating mode
- *Emergency kit (1h/3h)
- *Microwave sensor
- *5700K-6500K
- *Security glass film
- *Protective cage for sports fields

Order Code	W	Lm	CCT	L (mm)	Kg
07308.4H.40.106	69	10500	4000	445	3,5
07308.6H.40.172	110	16700	4000	595	5,1
07308.7H.40.228	145	20800	4000	745	6,6

LIGHT DISTRIBUTION CURVE

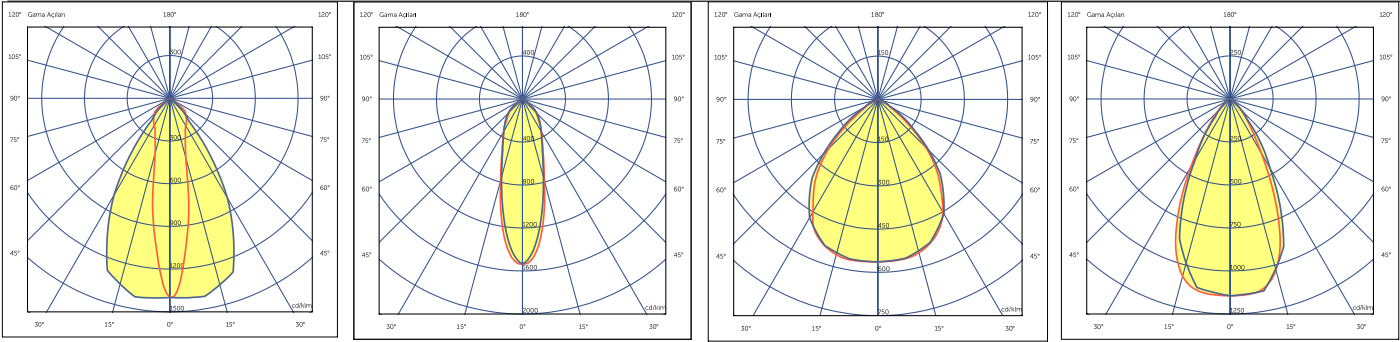

20°x100° Beam Angle 30° Beam Angle 60° Beam Angle 90° Beam Angle

Note, different optic options may be offered depending on the area of use.

EMERGENCY LIGHTING KIT BOX MODEL

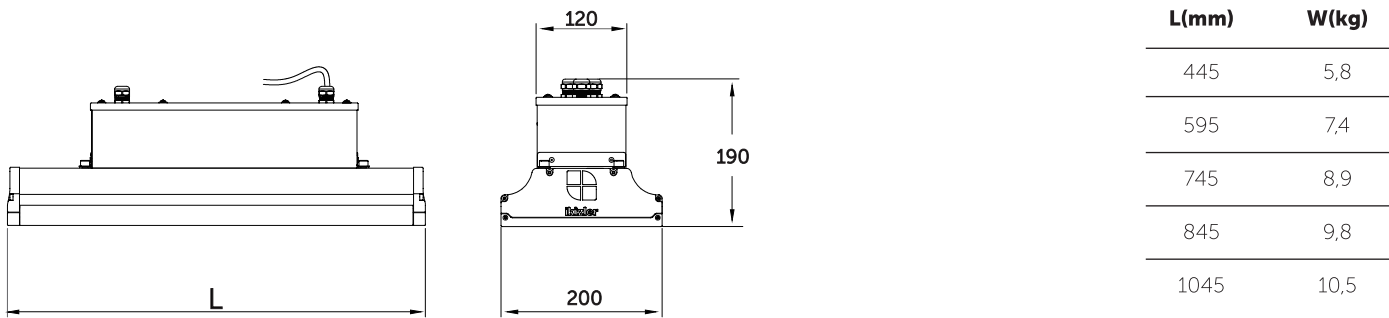

MOUNTING EQUIPMENT TYPES

Wall and Cable Tray Mounting Set
With 15° Angular Adjustment Steps Product

Product Code
07308.000.000.004 (wall)
07308.000.000.003 (cable tray)

Busbar Mounting Set

Product Code
07308.000.000.006 (x:35/y:55mm)
07308.000.000.007 (x:21/y:61mm)

Suspendant Mounting Set

Product Code
07308.000.000.005

PRODUCT MOUNTING TYPES

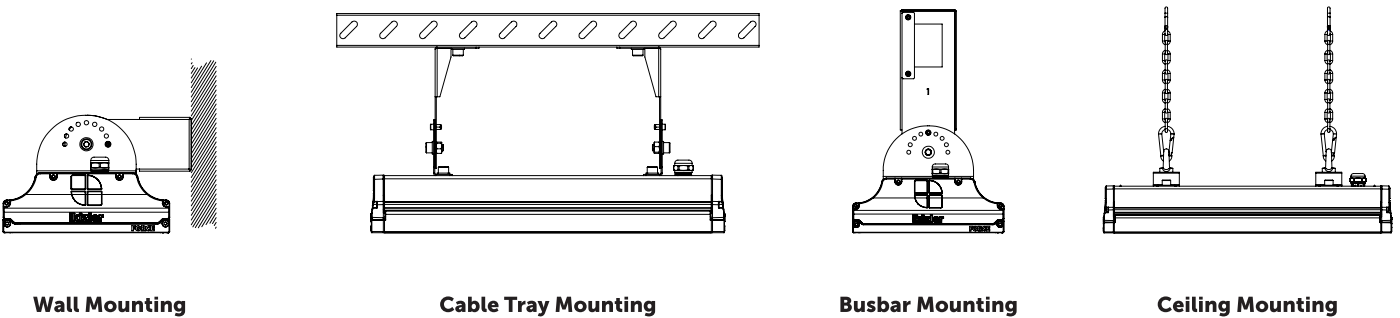

Wall Mounting Cable Tray Mounting Busbar Mounting Ceiling Mounting

PROTECTIVE CAGE MODEL



Product Code	L(mm)	W(kg)
07308.001.000.000	483	0.99
07308.001.000.002	643	1.17
07308.001.000.004	763	1.30
07308.001.000.005	883	1.45
07308.001.000.006	1083	1.67



FORCE WITH SENSOR



* It is suitable for sensor application integrated into the luminaire. does not require any extra assembly

* Mounting height is 15m max, suitable to install in most of ceiling

* Default Settings

Sensitivity: 100%, Hold time: 5s, Daylight sensor: Disable, Stand by period: 0s, Stand by DIM 10%

* Remote Settings

Check out the scenarios you can do with the remote control.



	Daylight Sensor Set up Daylight Sensor: 5Lux/15Lux/30Lux/50Lux/100Lux/150Lux/Disable
	Stand-by Period Set up Stand-by Period: 0s/10s/1min/3min/5min/10min/20min/30min/+∞ Note: Stand-by period is not applicable to ON-OFF Sensor
	Hold time Set up Hold time: 5s/30s/1min/3min/5min/10min/20min/30min
	Stand-by dim level Set up Stand-by dim level: 10%/20%/30%/50% Note: Stand-by DIM Level is not applicable to ON-OFF Sensor
	Detection Area Set up Detection Area: 25%/50%/75%/100%
	Remote Distance Toggle bottom can set the remote distance of remote control and sensor



ENVIRONMENT



Minimal Design and High Performance

HIGHLINE IP65 Industrial luminaire provides an efficient bright environment in spaces with 4-12m ceiling height. In the design of the product, the aim was to make it more useful in industrial environments with its thin linear structure and at the same time provide architectural elegance to these environments.

Its most important feature is that it can use lenses at different angles simultaneously in a single product, with two separate lens channels in the body structure.

A separate extrusion cooler profile has been designed within the body to prevent heat problems at high powers, without compromising the sharpness of the product's contours and flat surfaces. Both the outer body and the inner cooler profile are manufactured from aluminum material, making the product durable and environmentally friendly with high energy efficiency.

It differs from its counterparts with its sharp body design and angled finish on the end caps. It is compatible with different mounting types and its installation is fast and practical with open screw channels on the body.

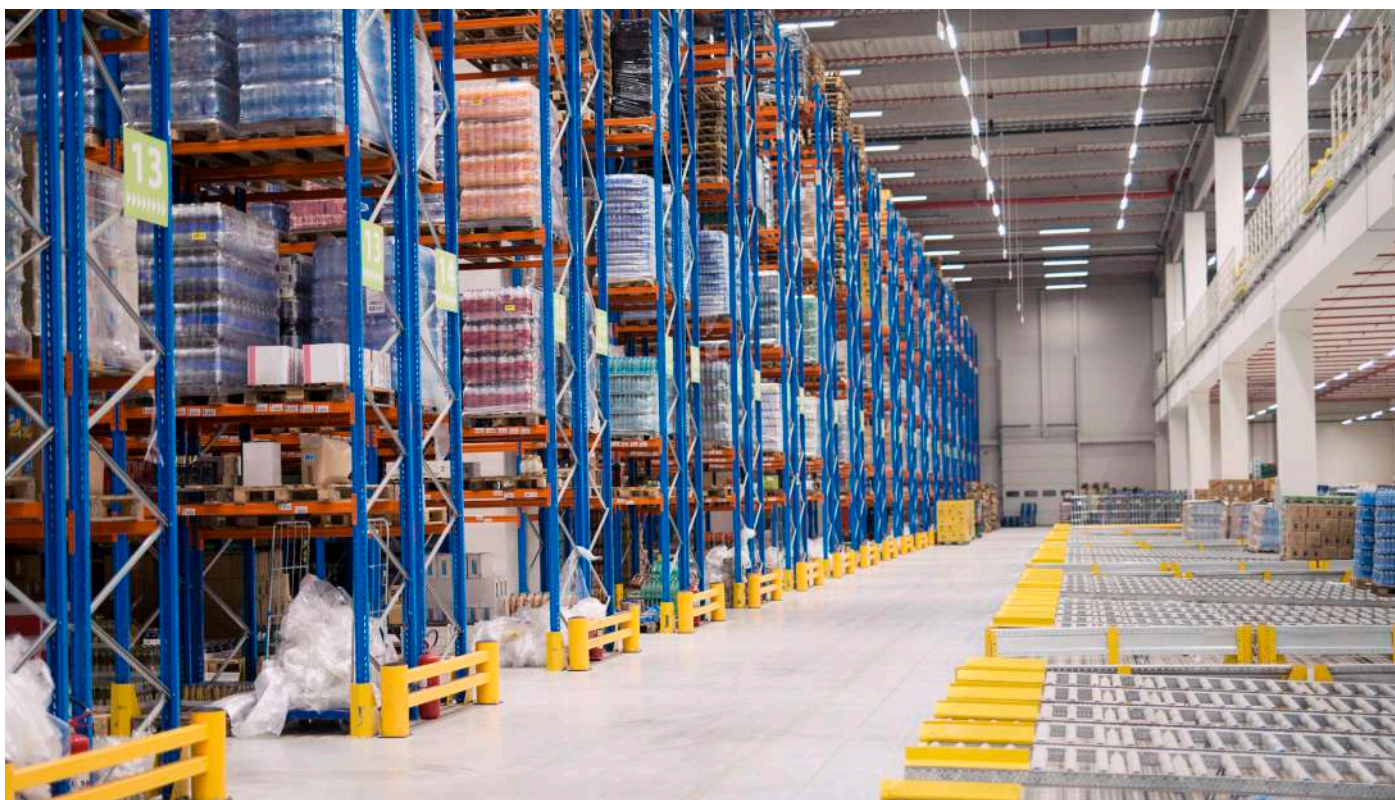

- Design compatible with different mounting and hanging details.
(Busbar, Cable tray, Angled apparatus)
- Different optics are suitable for lens use.
- Shock resistant body, tempered transparent glass.
- Has a long-lasting, non-deformation silicone gasket and sealing gasket.
- Screwless window opening and closing, fast and easy intervention to the LED-Lens-Driver part.
- Efficiency up to max. 140 lm/W.
- Side covers are made of special fireproof composite material.
- The closed-line design of the upper part of the body prevents the accumulation of dust and particles and does not pose a risk in terms of occupational safety.
- IP65 protected against liquid and dust.
- Impact resistance IK08.
- Cage protection system for sports fields.
- High bay sensor option (On-off, DALI)
- Suitable design for wireless connectivity technology.

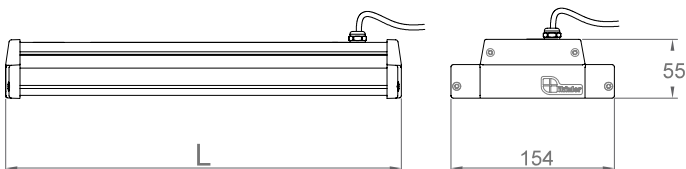

MECHANICAL SPECIFICATIONS

Body	Electrostatic powder coated aluminum profile
Diffuser	Tempered clear glass
Ingress Protection	IP65
Impact Protection	IK08
Cable	3 x 0,75 mm ²
RAL Code	RAL 7016
Mounting Type	Cable tray/Busbar/Surface mounted

OPTICAL SPECIFICATIONS

Optic	High efficiency acrylic lens (PMMA)
Beam Angles	90°x100°, 40°x100° Symetrical/ 2x25° Asymetrical
Unified Glare Rating (UGR)	≤ 25
Color Rendering Index (CRI)	Ra ≥ 80
Color Temperature	Standard 4000K

ELECTRICAL SPECIFICATIONS

Driver	Constant current output , Pf>0.95 Industry series
Operating Temperature	-20 °C/+45°C
Input Voltage / Line Frequency	220 -240 VAC / 50- 60 Hz
LED Life Time	L90B10>50.000 hours
Surge Protection Devices (SPD)	Up to 2 kV (L-N) / (L/N-PE)
Glow Wire	650°C
Class-I	

OPTIONS

- *DALI DIM
- *1-10V DIM
- *DC operating mode
- *Emergency kit (1h/3h)
- *Microwave sensor
- *5700K-6500K
- *Security glass film
- *Protective cage for sports fields
- *Built-in power input connector

Order Code	W	Lm	CCT	L (mm)	Kg
07309.06.40.100	75	10000	4000	580	3
07309.09.40.140	110	14500	4000	860	3,5
07309.12.40.200	150	20000	4000	1140	4

LIGHT DISTRIBUTION CURVE

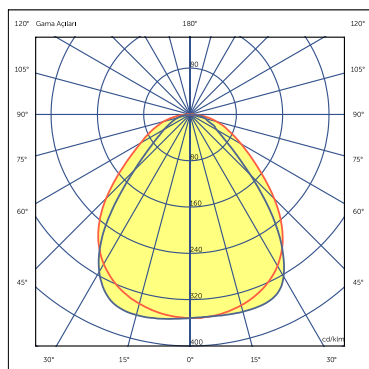

90°x100° Beam Angle

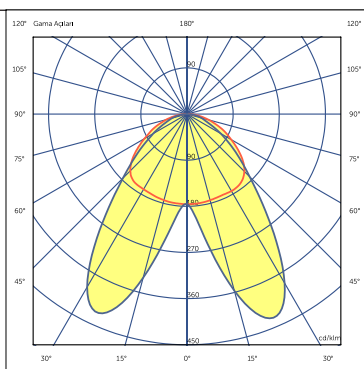

2x25° Double Asymmetric Beam Angle

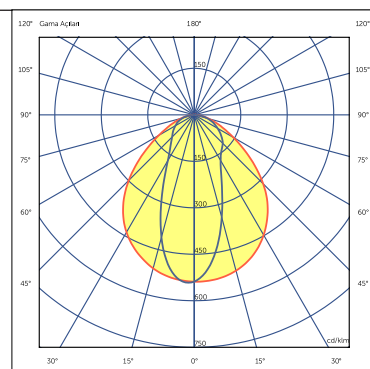

40°x100° Beam Angle

EMERGENCY LIGHTING KIT BOX MODEL

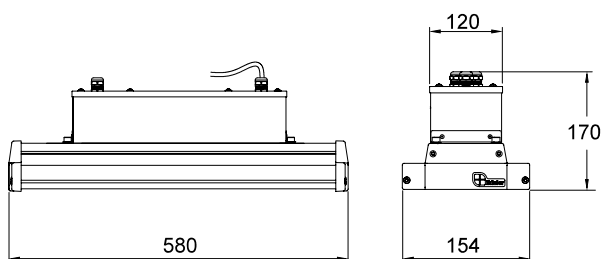

Note,
For the 58cm length option, the Emergency kit box
option must be used

BUILT-IN POWER CONNECTOR



3 Pole x 1,5 mm2...2,5mm2 IP68 Power Connector

Product Code :
YRKNT.100.000 Male connector (built-in)
YRKNT.100.001 Female connector

MOUNTING EQUIPMENT TYPES

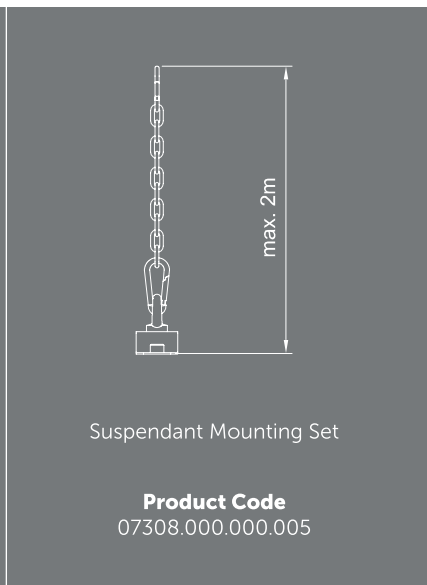
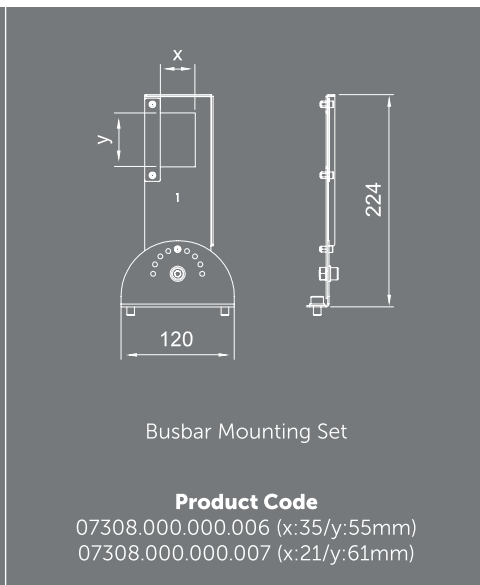
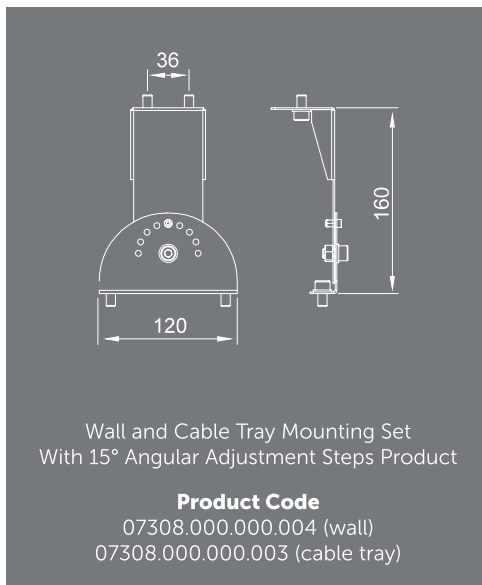

PRODUCT MOUNTING TYPES

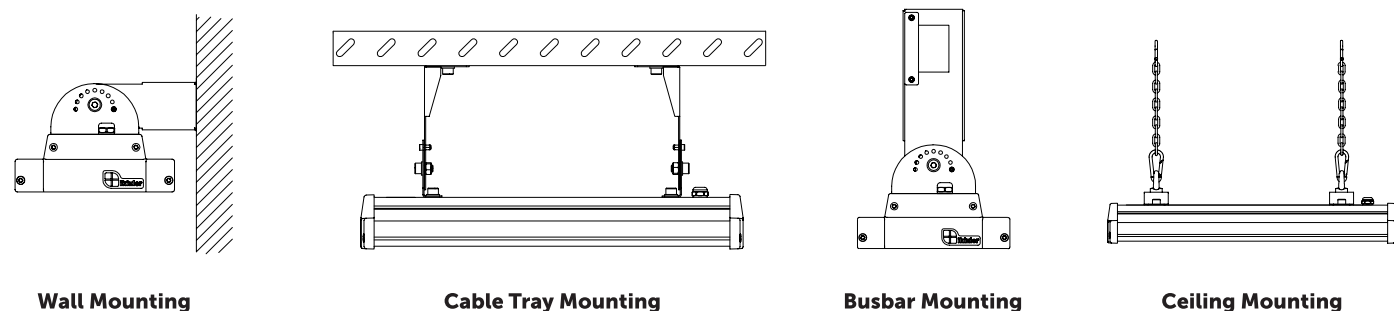

GETTO



GETTO high bay luminaire is a powerful lighting solution to illuminate large areas from 8-15 m high ceilings in warehouses, factories, workshops, gyms, supermarkets, exhibition halls, airports.

Getto high bay luminaire is impact resistant and has excellent thermal heat distribution, thanks to its aluminum injection body structure and polycarbonate diffuser.

Using high efficiency LED chips and drivers, the fixture has a lifespan of at least 50.000 and at most 100.000 hours.

- IP65 protected against liquid and dust.
- Impact protection IK10.
- Possibility of replaceable components.
- Busbar, pendant, cable tray and wall mounting options.

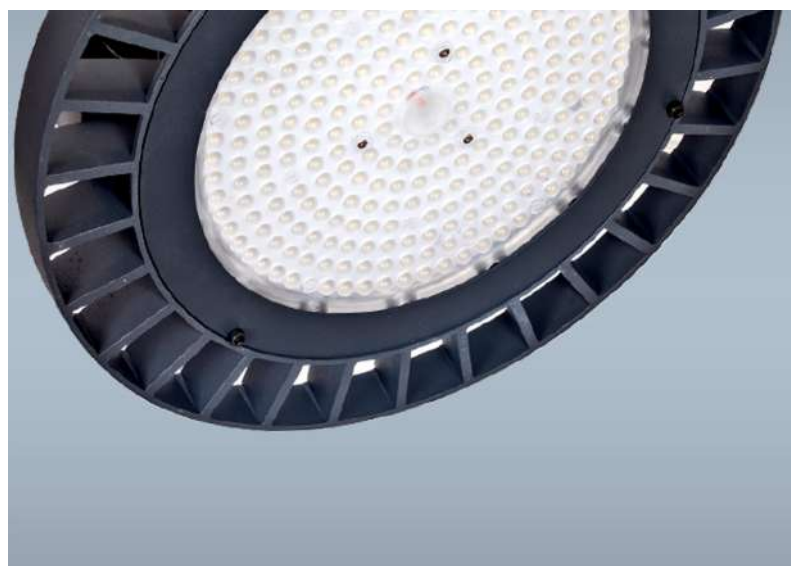

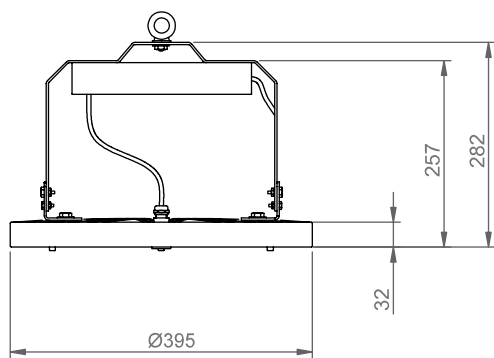

MECHANICAL SPECIFICATIONS

Body	Electrostatic powder coated injection aluminum
Ingress Protection	IP65
Impact Protection	IK10
Cable	3 x 1.00 mm ²
RAL Code	RAL 7016
Mounting Type	Cable tray/Busbar/Surface mounted

OPTICAL SPECIFICATIONS

Optic	High efficiency acrylic lens (PMMA)
Beam Angles	60°/90°/120° Symetrical
Unified Glare Rating (UGR)	≤ 25
Color Rendering Index (CRI)	Ra ≥ 80
Color Temperature	Standard 4000K

ELECTRICAL SPECIFICATIONS

Driver	Constant current output , Pf>0.95 Outdoor series (IP67)
Operating Temperature	-20 °C / +50 °C
Input Voltage / Line Frequency	220 -240 VAC / 50- 60 Hz
LED Life Time	L90B10>50.000 hours
Surge Protection Devices (SPD)	Up to 6 kV (L-N) / (L/N-PE)
Glow Wire	650°C
Class-I	

OPTIONS

- *DALI DIM
- *1-10V DIM
- *DC operating mode
- *Emergency kit (1h/3h)
- *Microwave sensor
- *5700K-6500K

Order Code	W	Lm	CCT	Kg
07306.39.40.080	60	8340	4000	4,2
07306.39.40.120	90	12500	4000	4,2
07306.39.40.150	124	17240	4000	4,2
07306.39.40.190	160	22240	4000	4,2

LIGHT DISTRIBUTION CURVE

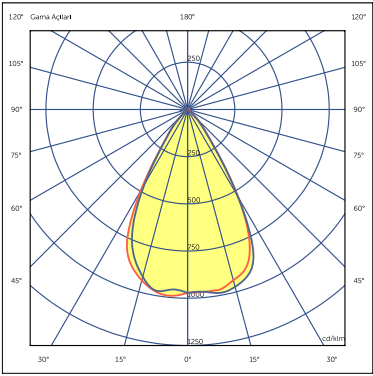

60° Beam Angle

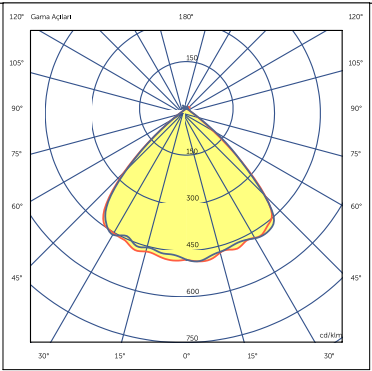

90° Beam Angle

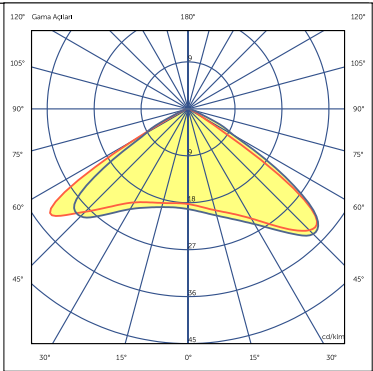

120° Beam Angle

EMERGENCY LIGHTING KIT BOX MODEL

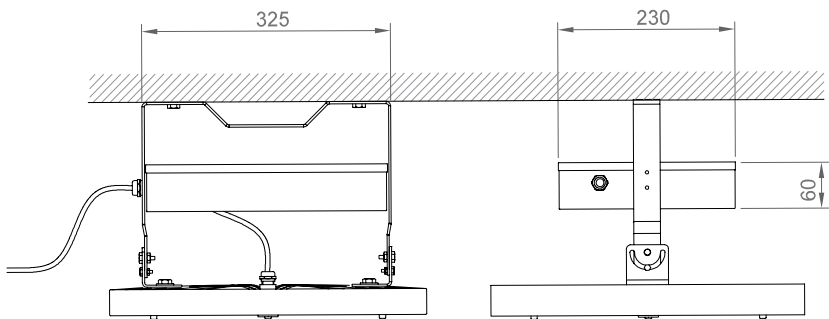

Weight (kg)
6,0

MOUNTING EQUIPMENT TYPES

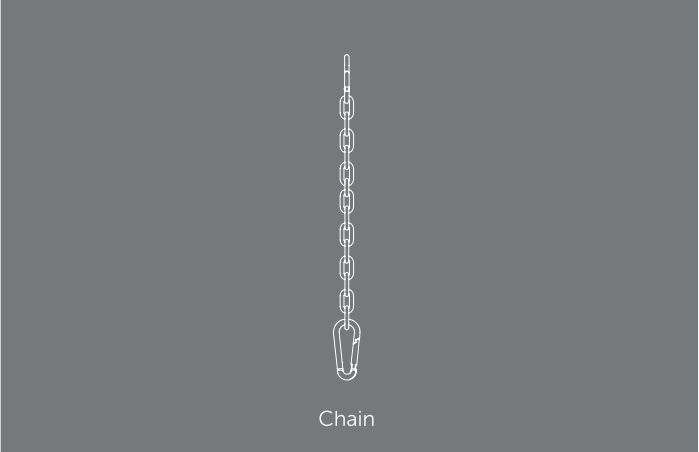
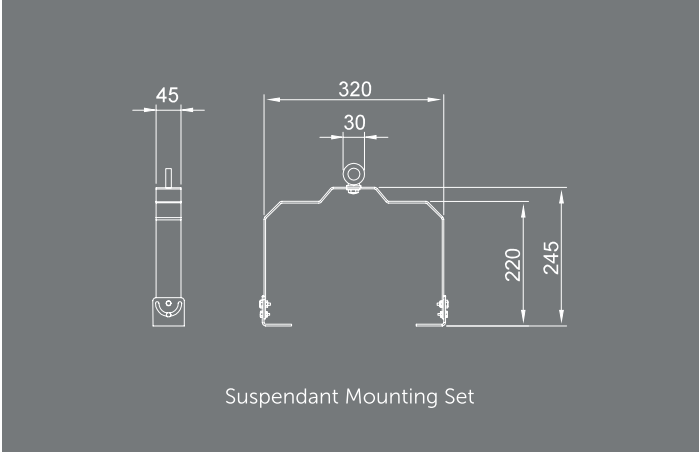
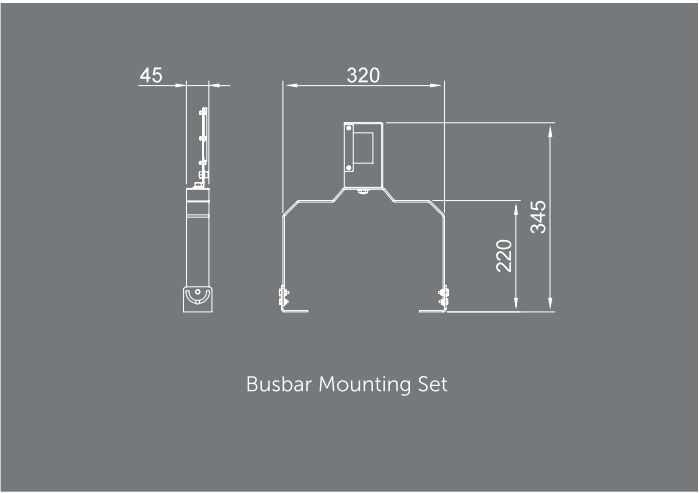
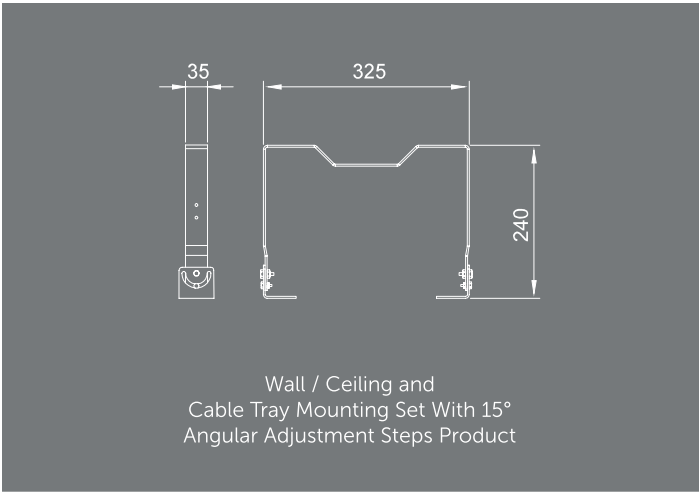



STRONG



STRONG is an IP65 luminaire designed for linear use in car parks, subways, cold storages and textile factories, thanks to its linear form and high strength aluminum injection body structure.

- Efficiency up to max 150 lm/W.
- 50.000 Hours lifespan.
- With sliding channel and stainless steel apparatus for easy assembly.
- Impact resistance IK08.
- Resistant to exhaust gas dust and moisture.
- Can be applied as wall lamp.

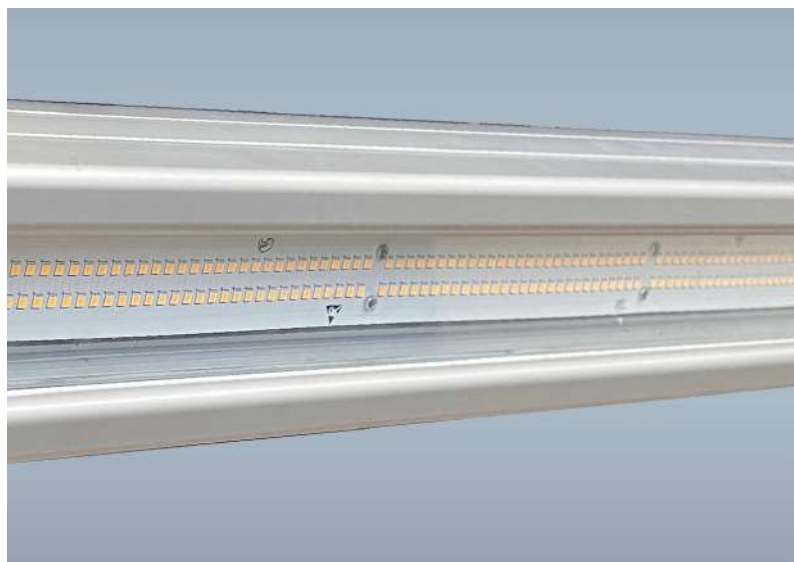



MECHANICAL SPECIFICATIONS

Body	Eloxal coated aluminum profile
Diffuser	Tempered clear glass
Ingress Protection	IP65
Impact Protection	IK08
Cable	3 x 0,75 mm ²
Mounting Type	Cable tray/Busbar/Surface mounted

OPTICAL SPECIFICATIONS

Optic	White PC reflector
Beam Angles	110° Symmetrical
Unified Glare Rating (UGR)	≤ 30
Color Rendering Index (CRI)	Ra ≥ 80
Color Temperature	Standard 4000K

ELECTRICAL SPECIFICATIONS

Driver	Constant current output , Pf>0.95 Industry series
Operating Temperature	-20 °C/+45 °C
Input Voltage / Line Frequency	220 -240 VAC / 50- 60 Hz
LED Life Time	L90B10>50.000 hours
Surge Protection Devices (SPD)	Up to 2 kV (L-N) / (L/N-PE)
Glow Wire	650°C
Class-I	

OPTIONS

- *DALI DIM
- *1-10V DIM
- *DC operating mode
- *Emergency kit (1h/3h)
- *Microwave sensor
- *5700K-6500K
- *Security glass film

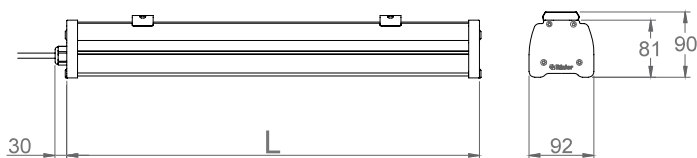

Order Code	W	Lm	CCT	L (mm)	Kg
01195.99.40.110	81	11700	4000	870	2
01195.99.40.150	105	15900	4000	1150	2,7
01195.99.40.180	133	19300	4000	1430	3,3

LIGHT DISTRIBUTION CURVE

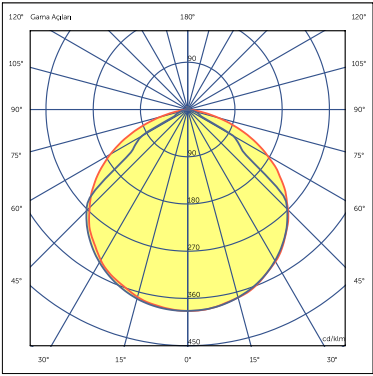

MOUNTING EQUIPMENT TYPES

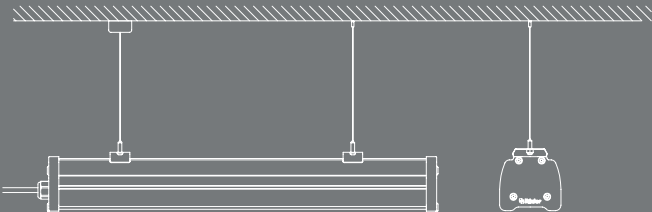

Suspendant Mounting Set



Surface Mounting Set

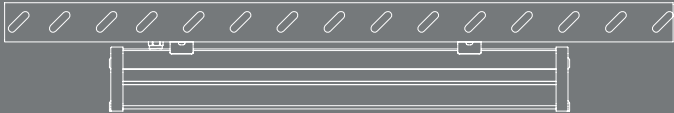

Busbar Mounting Set

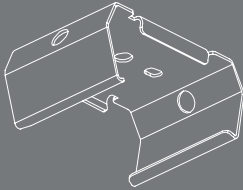

Mounting Bracket,
Stainless Steel Spring



*Optional,
IP65 Connector end of the cable
(End user)

PRODUCT MOUNTING TYPES

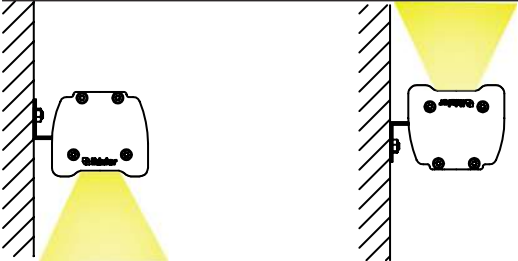

Wall Mounting Model
Up / Down Lighting



CORAL



CORAL Projectors series produce professional solutions according to needs with their stylish and slim structure in outdoor areas, facades and tunnels, industrial facilities, warehouses and sports halls.

CORAL projectors have excellent thermal heat dissipation with a robust structure with aluminum injection body structure.

Using high efficiency LED chips and drivers, the fixture has a lifespan of at least 50.000 and up to 100.000 hours.

All these extraordinary features distinguish CORAL from its peers. These lighting fixtures can be used compatible with smart control systems and DALI dimming solutions.



- Aesthetic and heat-dissipating design.
- Compatible with different lenses and optics.
- Tempered black silk-screened, impact-resistant glass.
- Console design that offers mounting options with 0°-180° angle options.
- High power LED module.
- The design of the cooling channels on the upper part of the body is positioned to ensure the flow of dust, dirt and water.
- Efficiency up to max 150 lm/W.
- CRI ≥ 70
- IP66 protection class against liquid and dust
- Impact resistance IK09

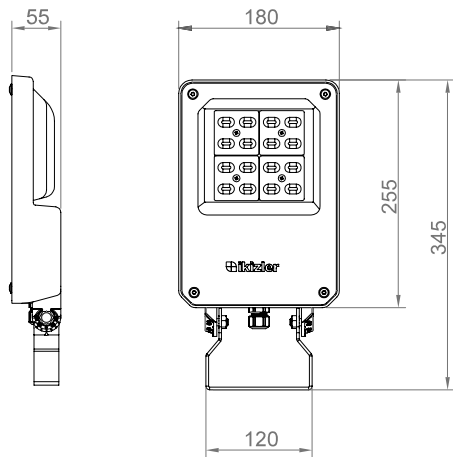

MECHANICAL SPECIFICATIONS

Body	Electrostatic powder coated aluminum Injection
Diffuser	Tempered clear glass
Ingress Protection	IP66
Impact Protection	IK09
Cable	3 x 0,75 mm ²
RAL Code	RAL 9005

OPTICAL SPECIFICATIONS

Optic	High efficiency acrylic lens (PMMA)
Beam Angles	30°/60°/90°/120° Symetrical / Asymetrical
Unified Glare Rating (UGR)	≤ 25
Color Rendering Index (CRI)	Ra ≥ 70
Color Temperature	Standard 4000K

ELECTRICAL SPECIFICATIONS

Driver	Constant current output , Pf>0.95
Operating Temperature	-20 °C/+50 °C
Input Voltage / Line Frequency	220 -240 VAC / 50- 60 Hz
LED Life Time	L90B10>50.000 hours
Surge Protection Devices (SPD)	Up to 2 kV (L-N) / (L/N-PE)
Glow Wire	650°C
Class-I	

OPTIONS

- *DALI DIM
- *DC operating mode
- *5700K-6500K

Order Code	W	Lm	CCT	Kg
09294.23.40.040	34	4600	4000	2,4
09294.23.40.045	40	5500	4000	2,4
09294.23.40.095	68	9500	4000	2,6

LIGHT DISTRIBUTION CURVE

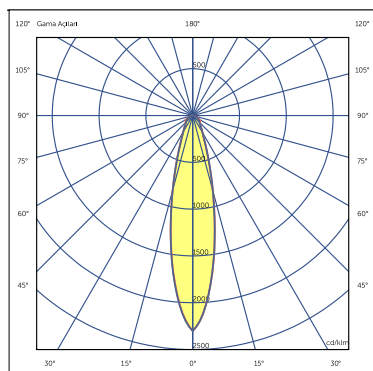

30° Beam Angle

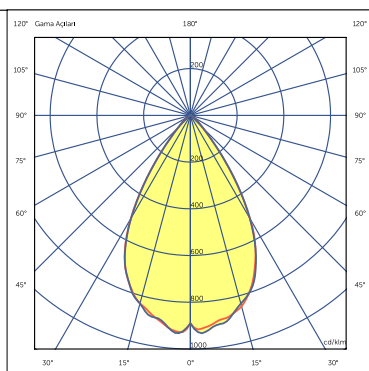

60° Beam Angle

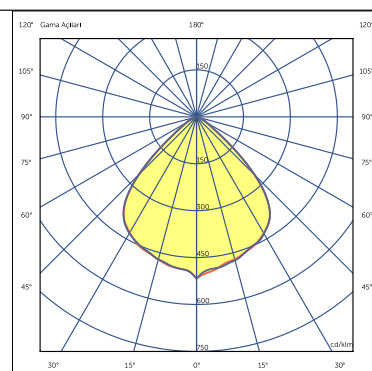

90° Beam Angle

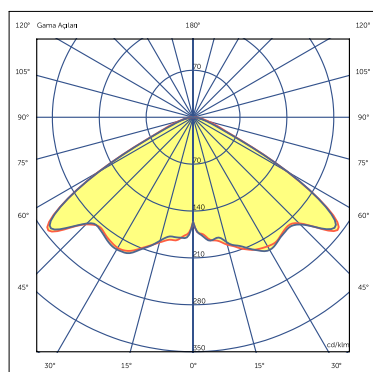

120° Beam Angle

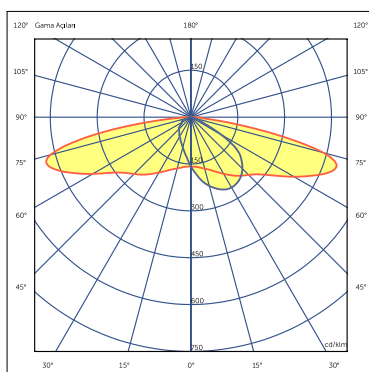

Asym Beam Angle

MOUNTING EQUIPMENT TYPES

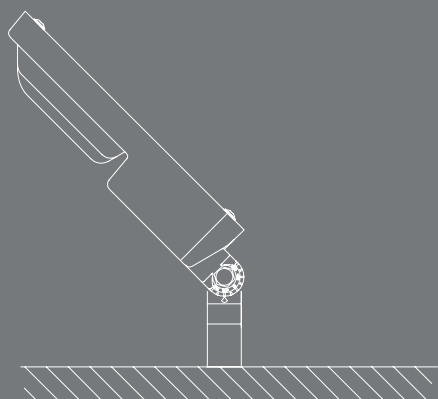

Floor and Wall Mounting Bracket

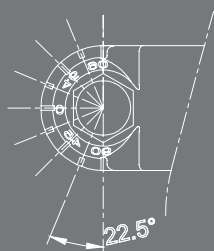

With 22.5° Angular Adjustment Steps Product

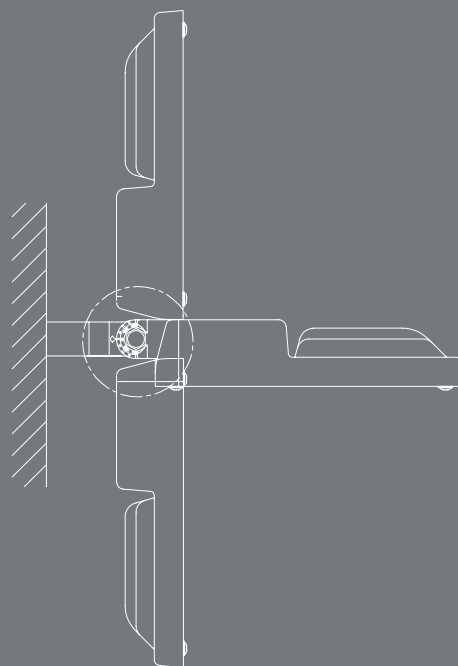

Wall Mounting Bracket

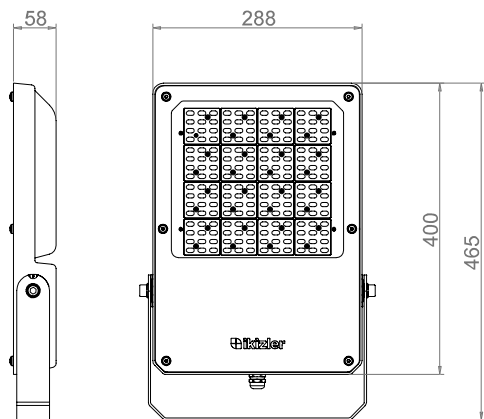

MECHANICAL SPECIFICATIONS

Body	Electrostatic powder coated aluminum Injection
Diffuser	Tempered clear glass
Ingress Protection	IP66
Impact Protection	IK09
Cable	3 x 0,75 mm ²
RAL Code	RAL 9005

OPTICAL SPECIFICATIONS

Optic	High efficiency acrylic lens (PMMA)
Beam Angles	18°/30°/60°/90°/120° Symetrical / Asymetrical
Unified Glare Rating (UGR)	≤ 25
Color Rendering Index (CRI)	Ra ≥ 70
Color Temperature	Standard 4000K

ELECTRICAL SPECIFICATIONS

Driver	Constant current output , Pf>0.95
Operating Temperature	-20 °C/+50 °C
Input Voltage / Line Frequency	220 -240 VAC / 50- 60 Hz
LED Life Time	L90B10>50.000 hours
Surge Protection Devices (SPD)	Up to 4 kV (L-N) / (L/N-PE)
Glow Wire	650°C
Class-I	

OPTIONS

- *DALI DIM
- *ASTRO DIM
- *DC operating mode
- *5700K-6500K
- *10kV SPD

Order Code	W	Lm	CCT	Kg
09294.29.40.090	70	9100	4000	7,8
09294.29.40.120	100	13000	4000	7,8
09294.29.40.150	120	15600	4000	7,8
09294.29.40.280	190	28000	4000	7,8

LIGHT DISTRIBUTION CURVE

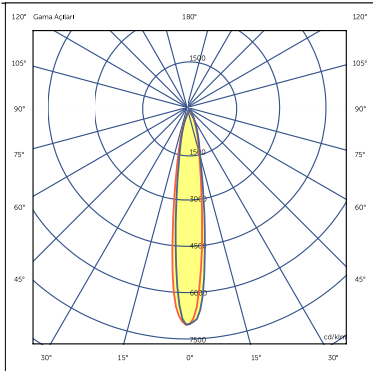

18° Beam Angle

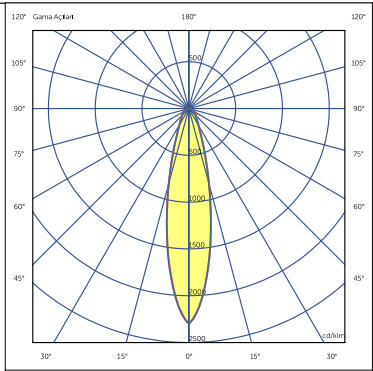

30° Beam Angle

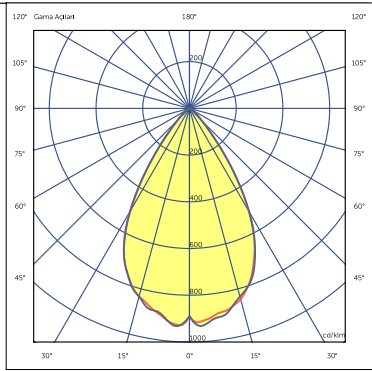

60° Beam Angle

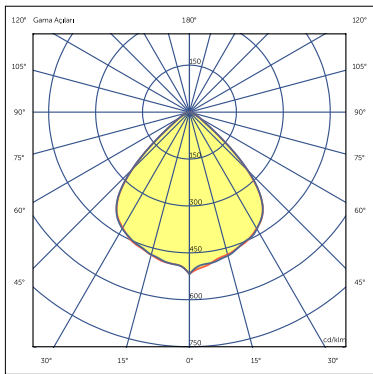

90° Beam Angle

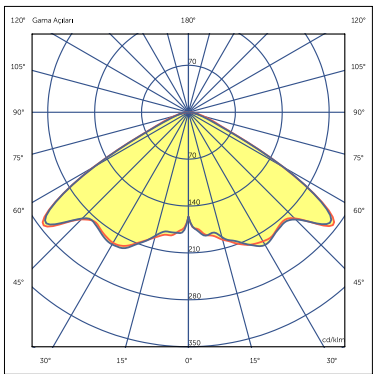

120° Beam Angle

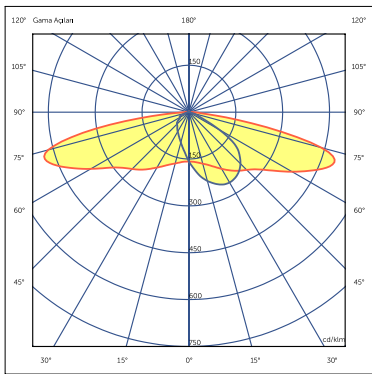

Asym Beam Angle

MOUNTING EQUIPMENT TYPES

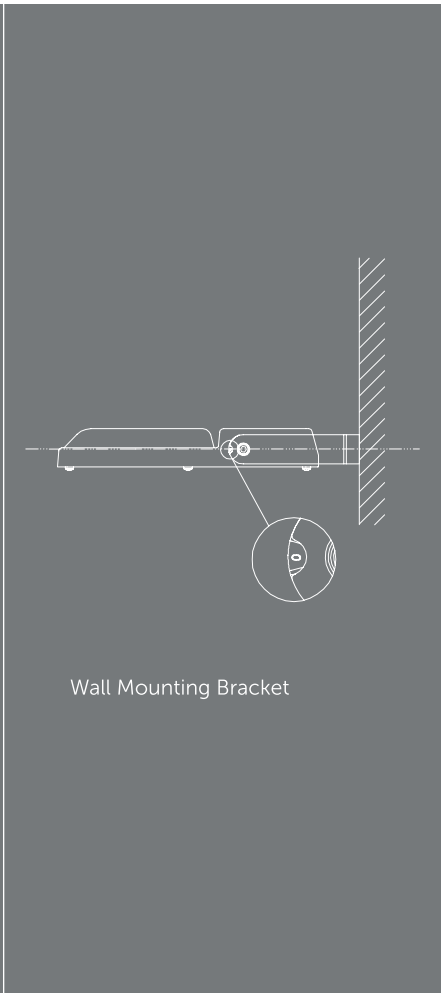
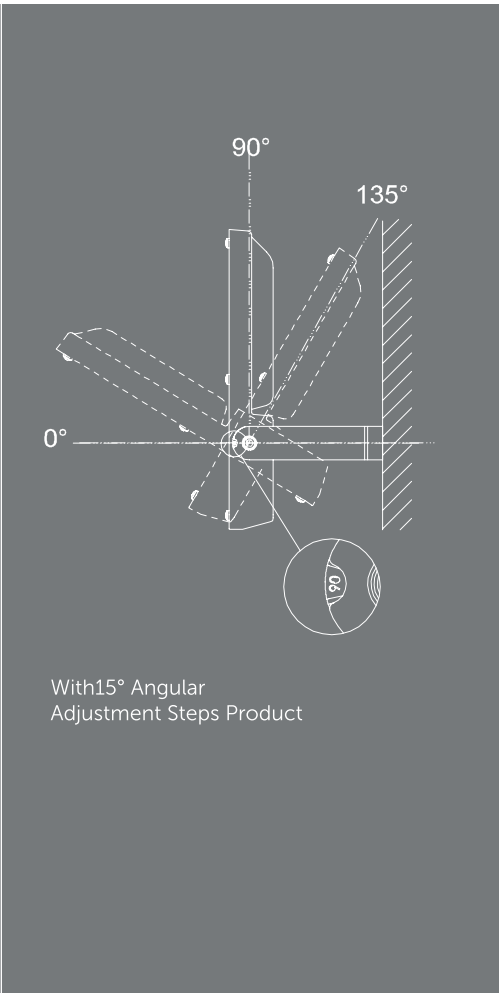
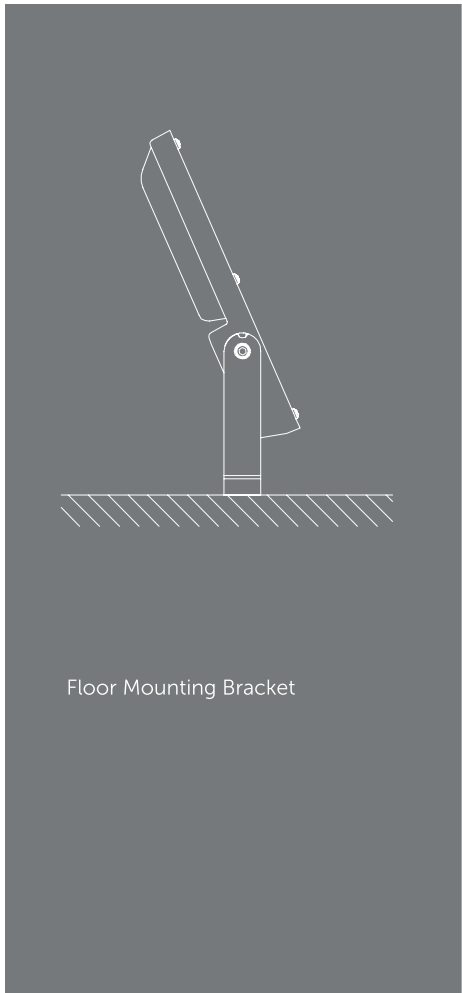

MINSU



■ MINSU is an IP65 luminaire designed as an economical solution for industrial and wet areas with its slim form and aluminum profile body structure.

- Efficiency up to max. 140 lm/W
- 50,000 Hours lifespan
- With sliding channel and stainless steel apparatus for easy assembly
- Impact resistance IK09



MECHANICAL SPECIFICATIONS

Body	Eloxal coated aluminum profile
Ingress Protection	IP65
Impact Protection	IK09
Cable	3 x 0,75 mm ²
Color	Eloxal grey
Mounting Type	Cable tray/Surface mounted

OPTICAL SPECIFICATIONS

Optic	High efficiency opal diffuser
Beam Angles	130° Symetrical
Unified Glare Rating (UGR)	≤ 25
Color Rendering Index (CRI)	Ra ≥ 80
Color Temperature	Standard 4000K

ELECTRICAL SPECIFICATIONS

Driver	Constant current output , Pf>0.95
Operating Temperature	-20 °C/+50 °C
Input Voltage / Line Frequency	220 -240 VAC / 50- 60 Hz
LED Life Time	L90B10>50.000 hours
Surge Protection Devices (SPD)	Up to 2 kV (L-N) / (L/N-PE)
Glow Wire	650°C
Class-I	

OPTIONS

- *DALI DIM
- *1-10V DIM
- *DC operating mode
- *Emergency kit (1h/3h)
- *Microwave sensor
- *5700K-6500K

Order Code	W	Lm	CCT	L (mm)	Kg
07104.03.40.013	11	1390	4000	315	0,4
07104.04.40.016	16	2020	4000	455	0,5
07104.07.40.033	26	3180	4000	735	0,7
07104.08.40.037	29	3740	4000	875	0,8
07104.10.40.043	33	4260	4000	1015	1,0
07104.11.40.050	40	4960	4000	1115	1,6
07104.14.40.062	50	6200	4000	1435	1,9

LIGHT DISTRIBUTION CURVE

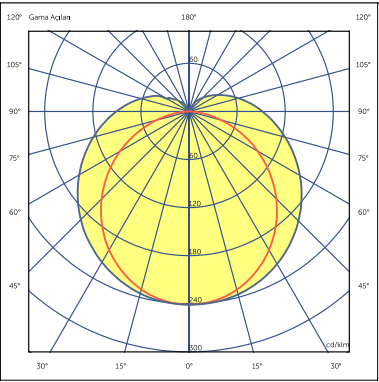

MOUNTING EQUIPMENT TYPES

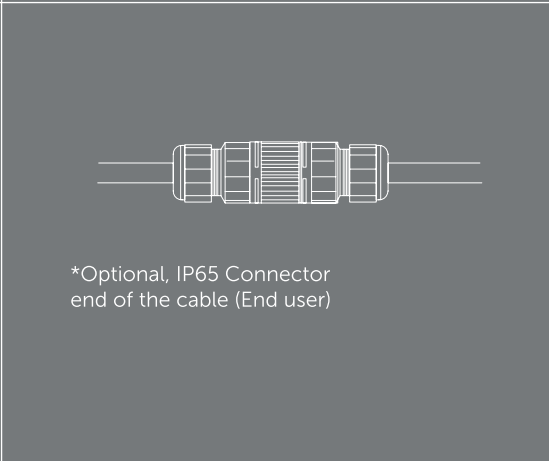
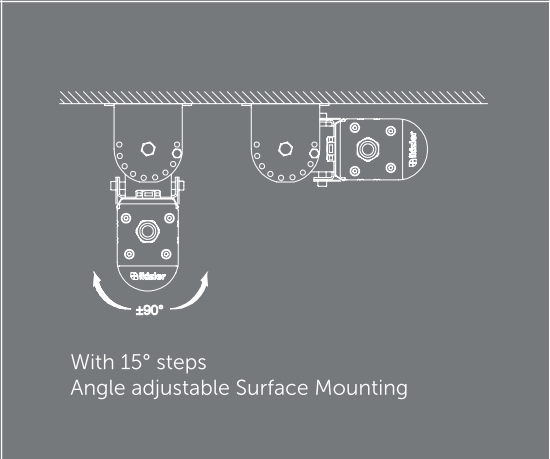
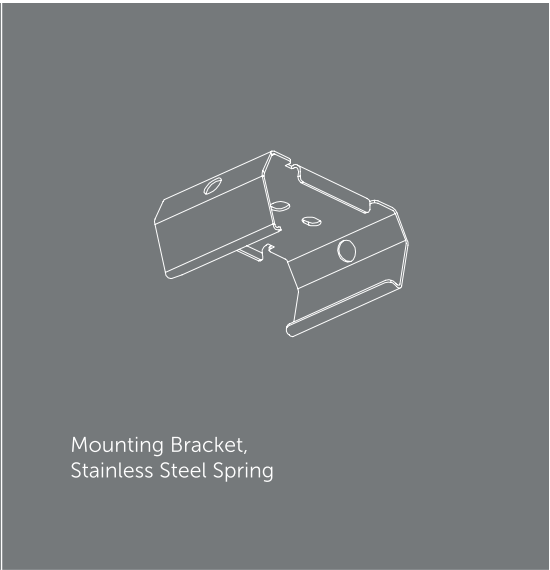
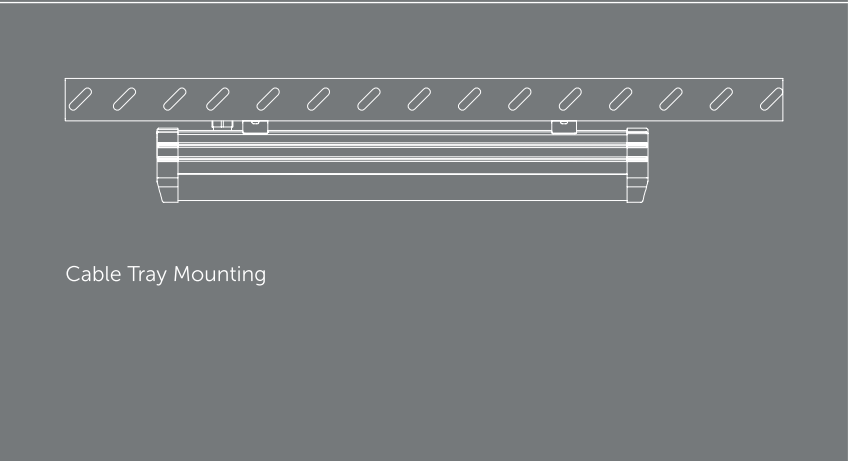
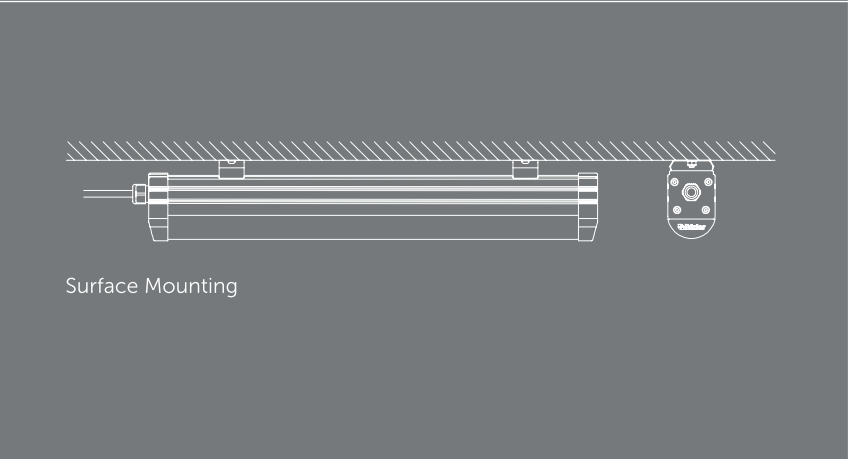
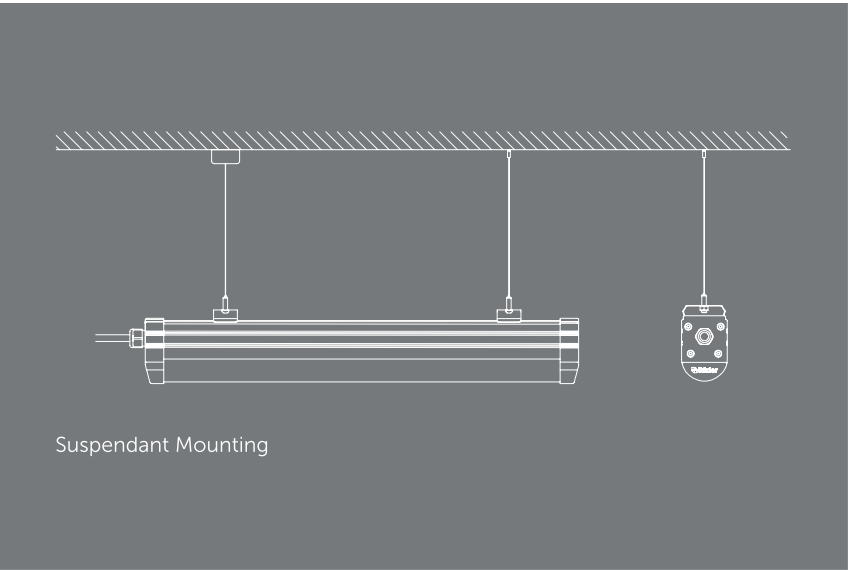



WATERLINE



WATERLINE is an IP54 fixture designed for linear use in industrial and wet areas with its linear form. In linear combination there is a transparent cover option for uninterrupted continuous light.

It is an ideal solution in places such as;

- * Subways
- * Textile Factories
- * Corridors/Walkways etc.



MECHANICAL SPECIFICATIONS

Body	Electrostatic powder coated aluminum profile
Ingress Protection	IP54
Impact Protection	IK09
Cable	3 x 0,75 mm ²
RAL Code	RAL 9016
Mounting Type	Cable tray/Surface mounted

OPTICAL SPECIFICATIONS

Optic	High efficiency sealed opal diffuser
Beam Angles	110° Symetrical
Unified Glare Rating (UGR)	≤ 25
Color Rendering Index (CRI)	Ra ≥ 80
Color Temperature	Standard 4000K

ELECTRICAL SPECIFICATIONS

Driver	Constant current output , Pf>0.95
Operating Temperature	-20 °C/+50 °C
Input Voltage / Line Frequency	220 -240 VAC / 50- 60 Hz
LED Life Time	L90B10>50.000 hours
Surge Protection Devices (SPD)	2 kV (L-N) / (L/N-PE)
Glow Wire	650°C
Class-I	

OPTIONS

- *DALI DIM
- *1-10V DIM
- *DC operating mode
- *Emergency kit (1h/3h)
- *Microwave sensor
- *5700K-6500K
- *RAL9005

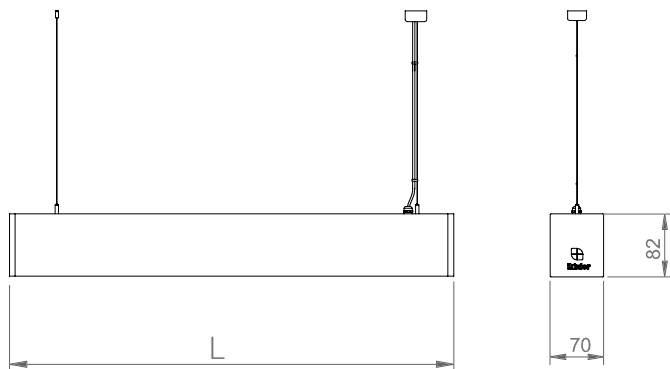

Order Code	W	Lm	CCT	L(mm)	Kg
01193.78.40.020	18	2000	4000	585	1,4
01193.78.40.030	27	3000	4000	865	2,0
01193.78.40.041	38	4100	4000	1145	2,6
01193.78.40.052	46	5200	4000	1425	3,2
01193.78.40.062	56	6150	4000	1705	3,8
01193.78.40.072	65	7200	4000	1985	4,5

LIGHT DISTRIBUTION CURVE

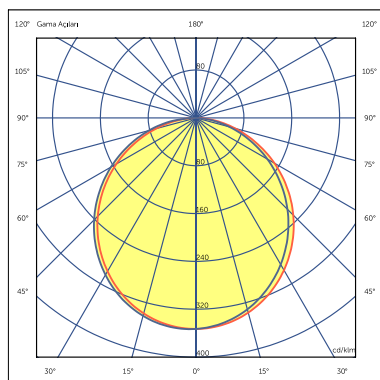

MOUNTING EQUIPMENT TYPES

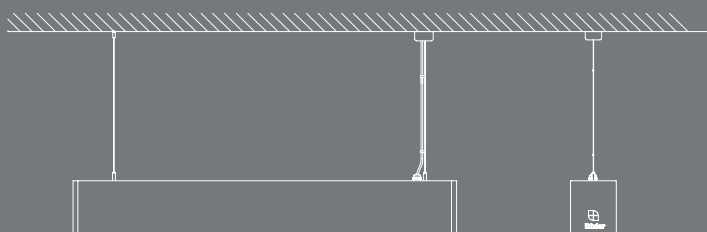

Suspendant Mounting

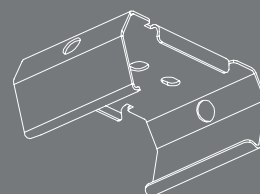

Mounting Bracket,
Stainless Steel Spring

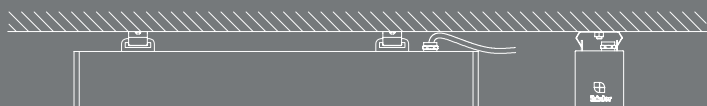

Surface Mounting



*Optional, IP65 Connector
end of the cable (End user)

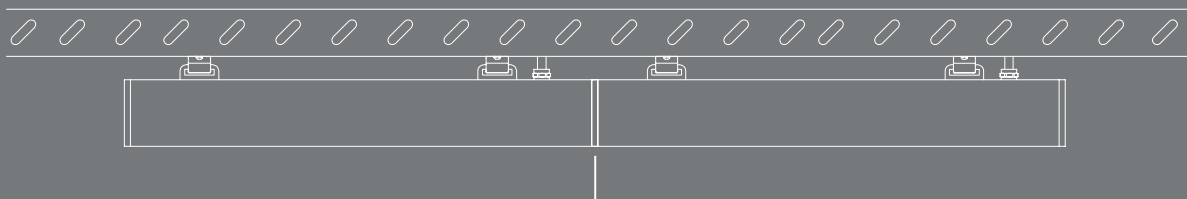

Cable Tray Linear Mounting-Continuous Lighting

Clear End Cap



BOLD



BOLD is an IP65 luminaire designed for linear use, especially in parking lots, subways and wet areas, thanks to its linear form and high strength aluminum extrusion body structure and transparent tempered glass.

- Efficiency up to max. 140 lm/W
- 50.000 Hours lifespan.
- With sliding channel and stainless steel apparatus for easy assembly.
- Impact resistance IK08.
- Resistant to exhaust gases, dust and moisture.
- It can be applied as wall lamp with adjustable angle bracket.

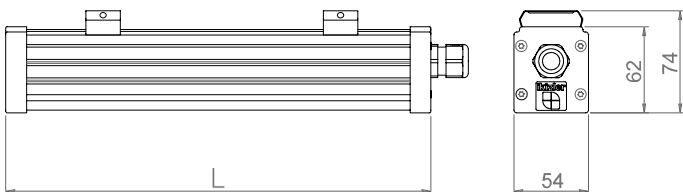

MECHANICAL SPECIFICATIONS

Body	Eloxal coated aluminum profile
Diffuser	Tempered clear glass
Ingress Protection	IP65
Impact Protection	IK08
Cable	3 x 0,75 mm ²
Mounting Type	Cable tray/Surface mounted

OPTICAL SPECIFICATIONS

Beam Angles	110° Symetrical
Unified Glare Rating (UGR)	≤ 25
Color Rendering Index (CRI)	Ra ≥ 80
Color Temperature	Standard 4000K

ELECTRICAL SPECIFICATIONS

Driver	Constant current output , Pf>0.95
Operating Temperature	-20 °C/+50 °C
Input Voltage / Line Frequency	220 -240 VAC / 50- 60 Hz
LED Life Time	L90B10>50.000 hours
Surge Protection Devices (SPD)	2 kV (L-N) / (L/N-PE)
Glow Wire	650°C
Class-I	

OPTIONS

- *DALI DIM
- *1-10V DIM
- *DC operating mode
- *Emergency kit (1h/3h)
- *Microwave sensor
- *5700K-6500K

Order Code	W	Lm	CCT	L (mm)	Kg
01192.66.40.012	10	1040	4000	316	
01192.66.40.021	18	2080	4000	596	
01192.66.40.031	26	3100	4000	876	
01192.66.40.042	35	4160	4000	1156	
01192.66.40.041	44	5000	4000	1436	

LIGHT DISTRIBUTION CURVE

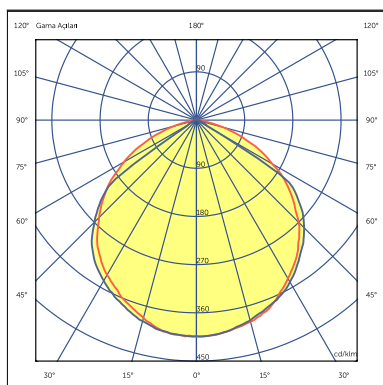

MOUNTING EQUIPMENT TYPES

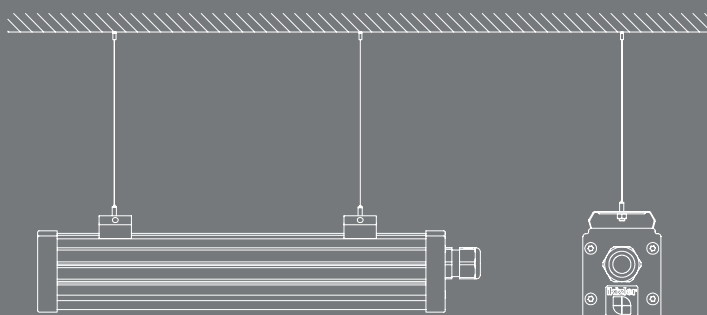

Suspending Mounting

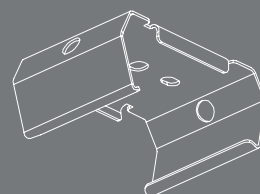

Mounting Bracket,
Stainless Steel Spring

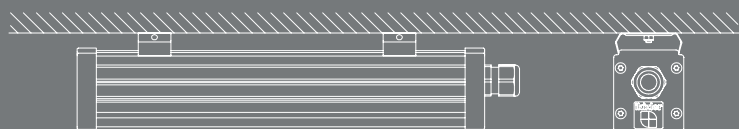

Surface Mounting

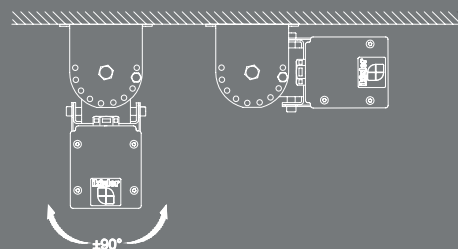

With 15° steps
Angle adjustable Surface Mounting

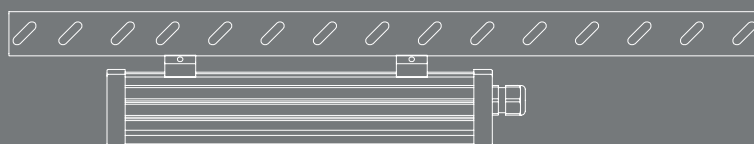

Cable Tray Mounting



*Optional, IP65 Connector
end of the cable (End user)



DRAW M



 DRAW M is an IP65 luminaire designed as an economical solution for industrial and wet areas with its slim form and UV protected PC extrusion body structure.

- Efficiency up to max. 140 lm/W
- 50,000 Hours lifespan,
- With sliding channel and stainless steel apparatus for easy assembly,
- Impact resistance IK09

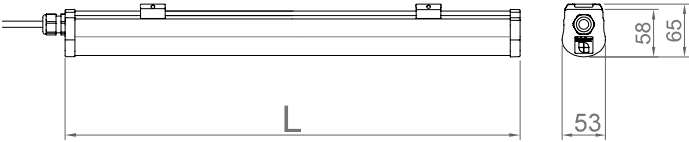

MECHANICAL SPECIFICATIONS

Body	Co-extruded PC
Ingress Protection	IP65
Impact Protection	IK09
Cable	3 x 0,75 mm ²
Body Color	Light grey
Mounting Type	Cable tray/Busbar/Surface mounted

OPTICAL SPECIFICATIONS

Optic	High efficiency co-extruded opal diffuser
Beam Angles	120° Symmetrical
Unified Glare Rating (UGR)	≤ 25
Color Rendering Index (CRI)	Ra ≥ 80
Color Temperature	Standard 4000K

ELECTRICAL SPECIFICATIONS

Driver	Constant current output , Pf>0.95
Operating Temperature	-20 °C/+50 °C
Input Voltage / Line Frequency	220 -240 VAC / 50- 60 Hz
LED Life Time	L90B10>50.000 hours
Surge Protection Devices (SPD)	2 kV (L-N) / (L/N-PE)
Glow Wire	650°C
Class-I	

OPTIONS

- *DALI DIM
- *1-10V DIM
- *DC operating mode
- *Emergency kit (1h/3h)
- *5700K-6500K

Order Code	W	Lm	CCT	L (mm)	Kg
07102.05.40.019	17	2200	4000	584	0,55
07102.08.40.029	25	3400	4000	864	0,70
07102.11.30.039	34	4800	4000	1144	0,85
07102.11.40.048	42	5800	4000	1424	1,0
07102.11.40.058	53	6800	4000	1424	1,0

Technical drawing of a bridge cross-section. The drawing shows a single-lane road with a central drainage ditch and side ditches. The road width is 10.00m, the ditch width is 1.00m, and the bridge structure is 10.00m wide. The drawing includes dimensions for the road width, ditch width, and bridge structure.

44



DRAW MV



 DRAW MV is an IP65 luminaire designed as an economical solution for industrial and wet areas with its slim form, openable side covers and UV protected PC extrusion body structure.

- Efficiency up to max. 140 lm/W
- 50.000 Hours lifespan.
- With sliding channel and stainless steel apparatus for easy assembly.
- Impact resistance IK09.

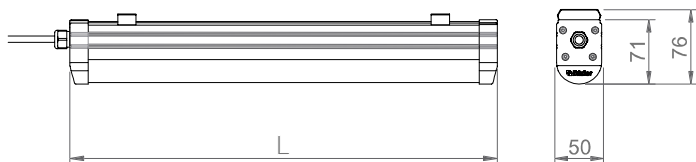

MECHANICAL SPECIFICATIONS

Body	Co-extruded PC
Ingress Protection	IP65
Impact Protection	IK09
Cable	3 x 0,75 mm ²
Body Color	Light grey
Mounting Type	Cable tray/Busbar/Surface mounted

OPTICAL SPECIFICATIONS

Optic	High efficiency co-extruded opal diffuser
Beam Angles	120° Symmetrical
Unified Glare Rating (UGR)	≤ 25
Color Rendering Index (CRI)	Ra ≥ 80
Color Temperature	Standard 4000K

ELECTRICAL SPECIFICATIONS

Driver	Constant current output , Pf>0.95
Operating Temperature	-20 °C/+50 °C
Input Voltage / Line Frequency	220 -240 VAC / 50- 60 Hz
LED Life Time	L90B10>50.000 hours
Surge Protection Devices (SPD)	2 kV (L-N) / (L/N-PE)
Glow Wire	650°C
Class-I	

OPTIONS

- *DALI DIM
- *1-10V DIM
- *DC operating mode
- *Emergency kit (1h/3h)
- *5700K-6500K

Order Code	W	Lm	CCT	L (mm)	Kg
07108.06.40.021	18	2300	4000	595	0,60
07108.09.40.028	21	2730	4000	875	0,75
07108.12.40.039	30	3900	4000	1155	1,1
07108.14.40.057	44	5720	4000	1430	1,3

LIGHT DISTRIBUTION CURVE

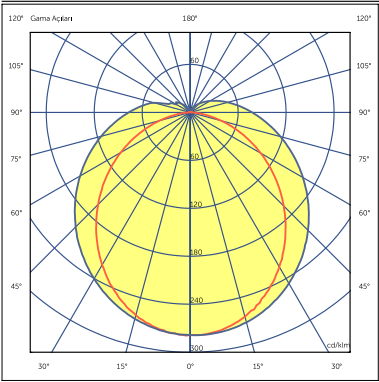

MOUNTING EQUIPMENT TYPES

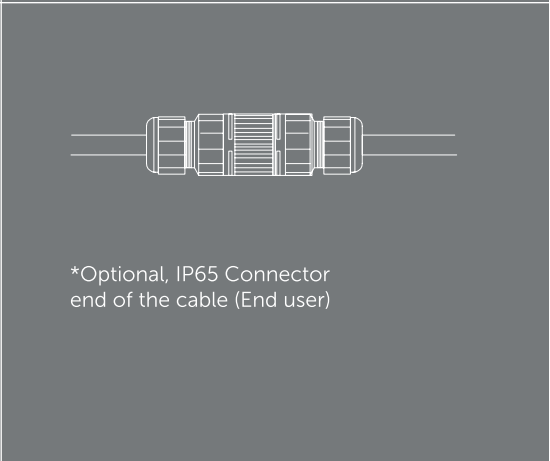
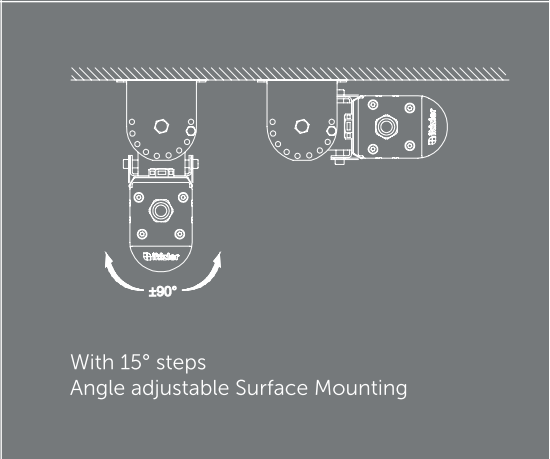
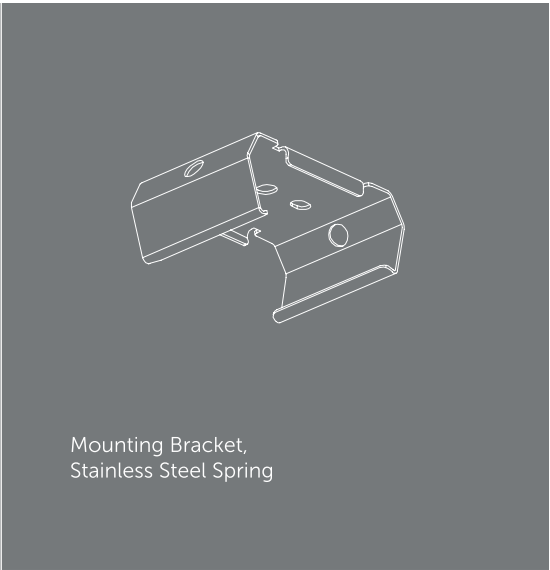
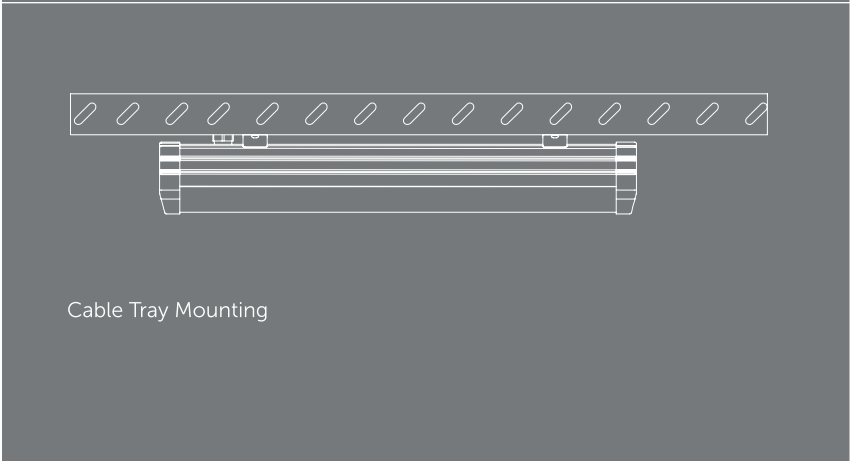
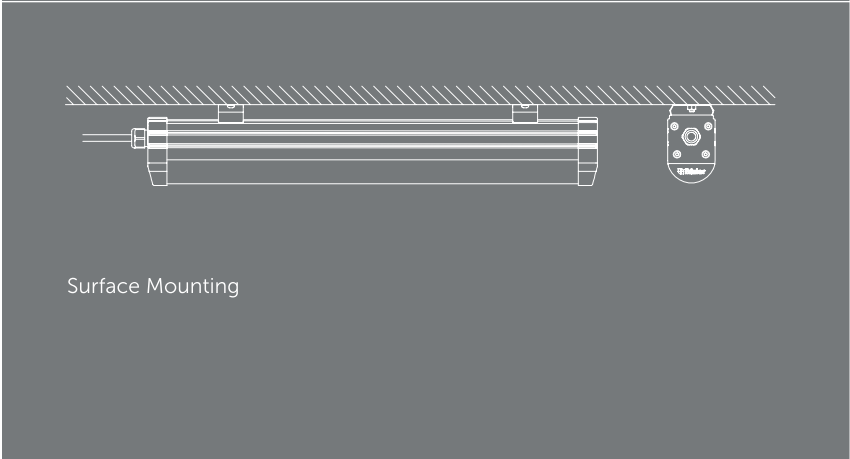
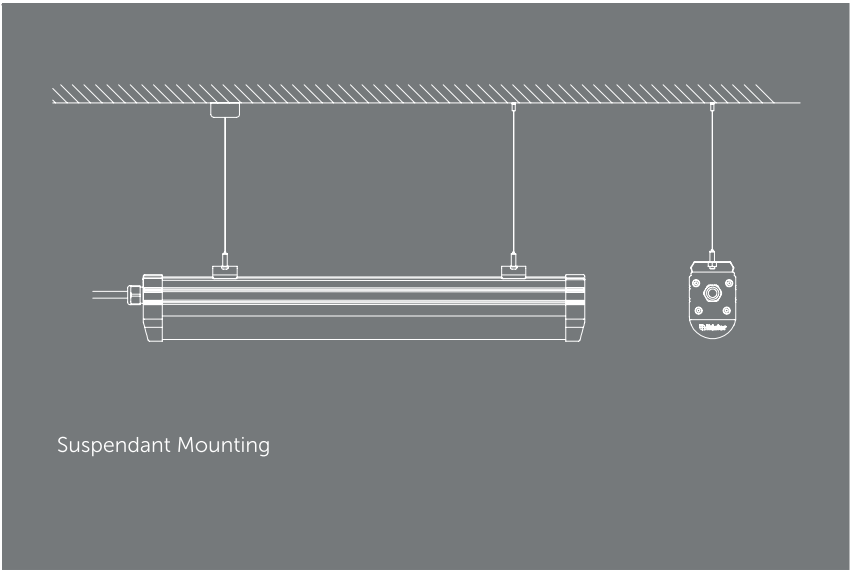



—

Trendyol	Ankara Warehouse
Tendyol	Trabzon Warehouse
Trendyol	Adana Warehouse
Iron and Steel Factory	İskenderun
Deteks Kimya A.Ş	İstanbul
Linea Dekor Factory	Kocaeli
Pulver Boya Factory	Kocaeli
Polifarma Pharmaceutical Plant	Çorlu
Namet Factory	Kocaeli
Embil Pharmaceutical Plant	Tekirdağ
Clariant Paint Factory	Kocaeli
Autoliv Teknopark Factory	Kocaeli
Assan Alüminyum Tuzla Factory	İstanbul
Aslan çimento factory	Kocaeli
Bayer A.Ş Factory	İstanbul
Malkara Birlik Milk and Dairy Products Factory	Tekirdağ
Aromsan Aromatik Gıda Factory	Gebze Kocaeli
Dalgakıran Kompresör Factory	Dilovası Kocaeli
Odelo Storage and Office Areas Şekerpinar	Şekerpinar Koceli

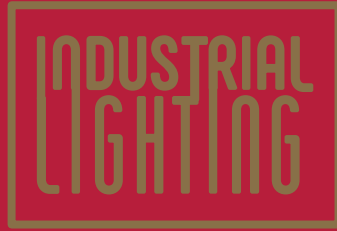

20
24 CATALOG



Head Office

Adress

Cevizli Mah. Tansel Cad.
No: 76 Kat 4 - Cevizli Kule-Cevizli
34865 Maltepe/İstanbul/TÜRKİYE

Phone +90 (216) 397 22 16

Fax +90 (216) 397 19 19

E-Mail info@ikizleraydinlatma.com

Factory

Adress

3.Organize San. Böl. 1. Yol.
No:68 Soğucak Köyü
Söğütölü/Sakarya/TÜRKİYE

Phone +90 (264) 290 40 10-11

Fax +90 (264) 290 40 12

E-Mail info@ikizleraydinlatma.com



/ikizleraydinlatma



/ikizlerlighting