

# Drax-A Batwing

Indoor Lighting - Waterproof



Colour Options



Ral 9006

## TECHNICAL INFORMATION

<b>Housing</b>	Extruded Aluminum Profile
<b>Side Cover</b>	PC Injection + Silicone Gasket
<b>Diffuser</b>	Batwing Lens + PC Opal
<b>Paint</b>	Anodized Coating

## OPTICAL SPECIFICATIONS

<b>Optics</b>	High Efficiency Batwing Lens
<b>Light Output Angle</b>	165°x130°
<b>UGR Value</b>	UGR ≤ 22
<b>CRI</b>	CRI ≥ 80
<b>Color Bin Value</b>	Mc Adams ≤ 3

## ELECTRICAL

<b>Power (W)</b>	21-54W
<b>Power Factor</b>	>0.95
<b>Light Source</b>	Mid Power LED
<b>Cabling</b>	Halojen-Free
<b>Input Voltage</b>	220-240V AC / 50-60 Hz
<b>LED Driver</b>	High Efficiency Constant Current Output
<b>Ambient Temperature</b>	-20°C / +50°C
<b>LED Lifetime L80B50</b>	>50.000 Hour

## OPTIONAL

- DALI	- 1-10V DIM
- DC Operation Mode	- Emergency Lighting Unit
- CRI > 90	- 2700K ~ 6500K
- Class-II Protection Class	- PIR Sensor
- AC-DC Supply(MBS)	

## ASSEMBLY

<b>Installation Type</b>	Surface Mounted
<b>Mounting Apparatus</b>	Metal Bracket



GLOW WIRE  
650°C



IP  
65

IK  
09

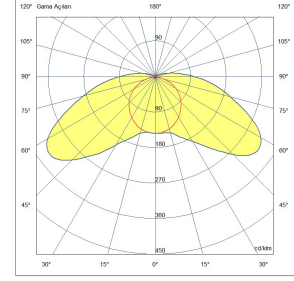
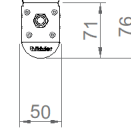
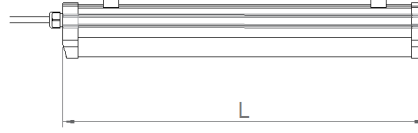

Order Code	W	Lm	Angle	CCT	CRI	L (mm)	Kg
07112.06.40.022	21	2520	165°-130°	4000K	Ra>80	580	0,5

